

ENUTRON AUTOMATION

QUIK-CUT



What is the **QUIK-CUT** ?

It is the sought after solution for the simple equation **"CUT DOWN SETUP TIME = \$\$"**. While traditional methods of measuring pieces manually, and then cutting, and repeating the entire process again, consumes valuable time and money, the Quik-Cut gets the job done... **QUIK!** A fast GO-TO gauge, your productivity and efficiency is surely to increase.

Why choose the Quik-Cut?

Do you desire to save time? Do you want to multiply your output? Do you want to increase productivity without sacrificing quality? If so, you are already on the right path by considering the Quik-Cut.

Applications:

Cutting

Drilling

Punching.....

ANY GAUGING NEEDS !!!

Fast GO-TO

SIMPLICITY

POWER

PRECISION

QUALITY



QUIK-CUT



Specifications:

Quik-Cut Standard

- Stroke: 10' (3.05m)
(other lengths available as custom order)
- Heavy duty steel construction

Dimensions:

- 137.79" (3500 mm) X 13.39" (340 mm) X 6.20"
(157.5mm)

Weight Range:

- Maximum 1,500 lbs (680.39 kg)
(on rollers)
- Heavier weight capacity optional

Drive-Type:

- Steel reinforced belt system
for enhanced precision
- Precision bearings
- Double-high precision guides

Dynamics:

- 5-level motions, offering variations in
acceleration/deceleration and speed

Accuracy:

- Repeatability: +/- 0.001"
- Precision: +/- 0.003"

CNC:

- Simple, LCD display control system
- Hard-drive capacity up to 200 programs
- Robust control enclosure for industrial
environment
- Choose either to fix mount it or mobile

Do not underestimate the Quik-Cut's simple design. The Quik-Cut has been engineered to take your production to the next level. Its high level construction and precision will ensure you that you will be nothing less than satisfied with the end result.

Features/Options



Heavy-Duty adjustable supports ensure that the Quik-Cut will be mounted firmly.



A clamping feature is also available to hold your parts during in-position movement.

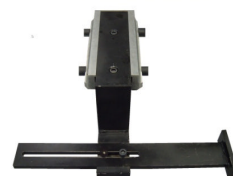
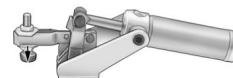

Robust, heavy duty steel finger. Full linear adjustment span of 10". You may also choose to modify with custom design finger.



3847 Geryville Pike

Pennsburg, PA 18073

Telephone: (215)-541-0696

Fax: (215)-541-0994

E-mail: info@enutron.com

www.enutron.com